

BR 120

BRONZE BALL VALVE

600 PSI / 41.4 BAR WOG

150 PSI / 10.3 BAR WSP

1/2"~1" FULL PORT

1 1/4"~4" CONVENTIONAL PORT

Conforms to MSS SP-110

ECI EUROPEAN
CASTING
INDUSTRY

www.ecivalve.it

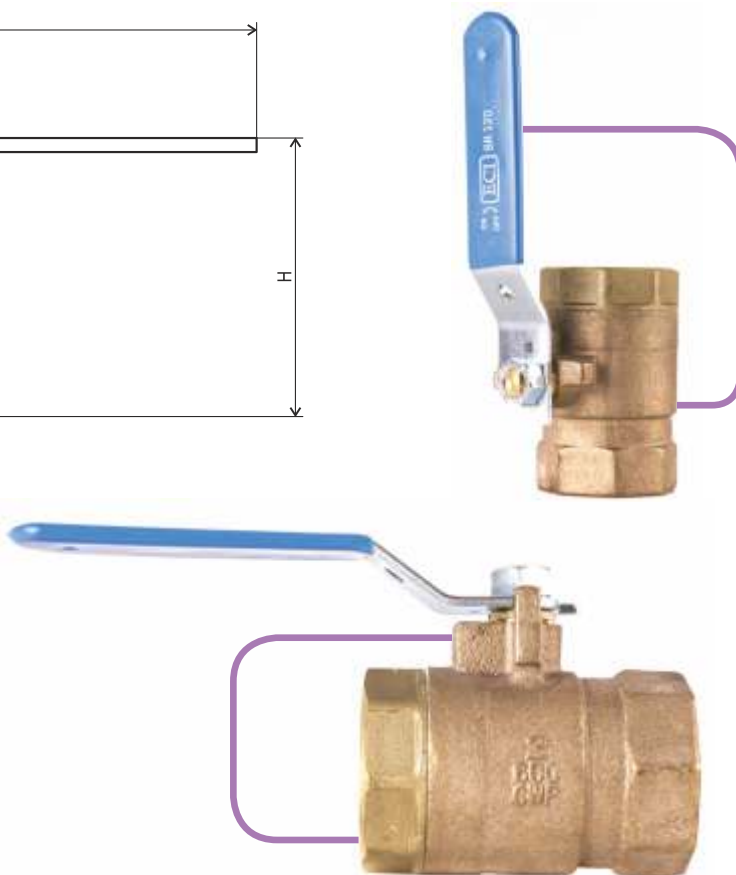
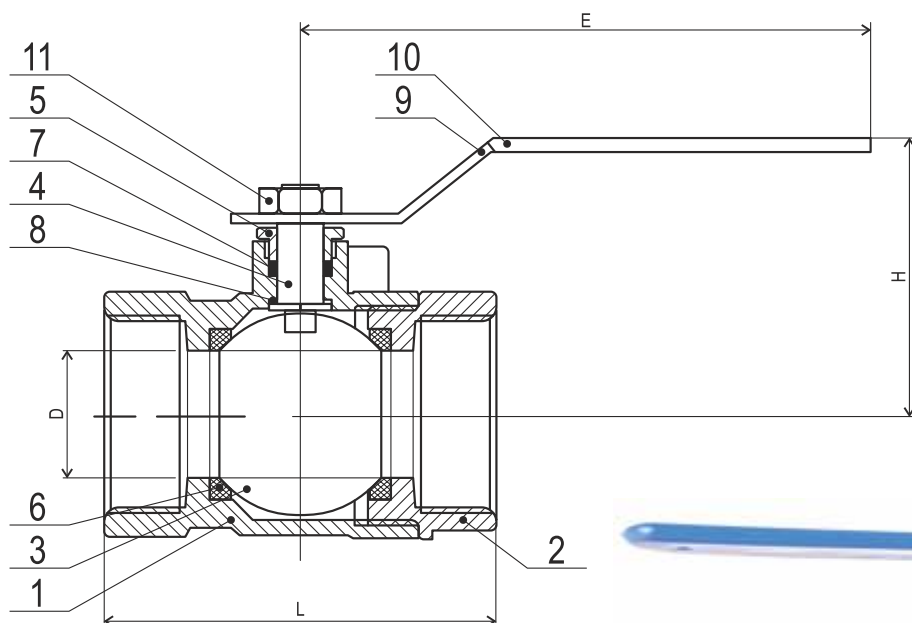

Specifications:

- WORKING PRESSURE:
600 PSI / 41.4 BAR WOG
150 PSI / 10.3 BAR WSP
- WORKING TEMPERATURE: $T \leq 140^{\circ}\text{C}$
- PORT SIZE:
1/2"~1" FULL PORT
1 1/4"~4" RED PORT (CONVENTIONAL)
- TESTING PRESSURE: 100 PSI AIR FOR SHELL & SEAT
- TAPER PIPE THREADED TO NPT AND ISO 7-1 (ex. BS-21)
- SUITABLE MEDIA: WATER, OIL, AIR & STEAM

Dimensions (mm)

DN	SIZE INCH	L	H	E	WEIGHT KGS
15	1/2"	61	48	102	0.399
20	3/4"	74	56	122	0.581
25	1"	86	65	122	0.889
32	1 1/4"	102	69	122	1.406
40	1 1/2"	109	79	175	2.177
50	2"	117	84	175	3.039
65	2 1/2"	150	91	175	3.856
80	3"	180	114	201	6.713

Material

No.	DESCRIPTION	BRONZE	LEAD FREE
1	Body	ASTM B584 C84400	ASTM C87850 or C89844
2	Tailpiece	ASTM B584 C84400	ASTM C87850 or C89844
3	Ball	ASTM B16 C36000	Stainless Steel 316
4	Stem	ASTM B16 C36000	ASTM C69300 or CW510L
5	Packing Nut	ASTM B16 C36000	ASTM C69300 or CW510L
6	Ball Seat	15% Glass RPTFE	15% Glass RPTFE
7	Packing	15% Glass RPTFE	15% Glass RPTFE
8	Thrust Washer	15% Glass RPTFE	15% Glass RPTFE
9	Handle	Steel-Zn.P.	Steel-Zn.P.
10	Handle Sleeve	Vinyl	Vinyl
11	Handle Nut	Steel-Zn.P.	Steel-Zn.P.



ECI EUROPEAN
CASTING
INDUSTRY

All data, descriptions and pictures contained in this leaflet may be subject to change without prior notice.

European Casting Industry Srl | Via D'Azeglio 57 | 40123 Bologna BO, Italia | P.Iva: 03228761205 | www.ecivalve.it | info@ecivalve.it